

GATEMATE SELF CLOSING RISING HINGE SET 45°

PRODUCT CODE: 0344511

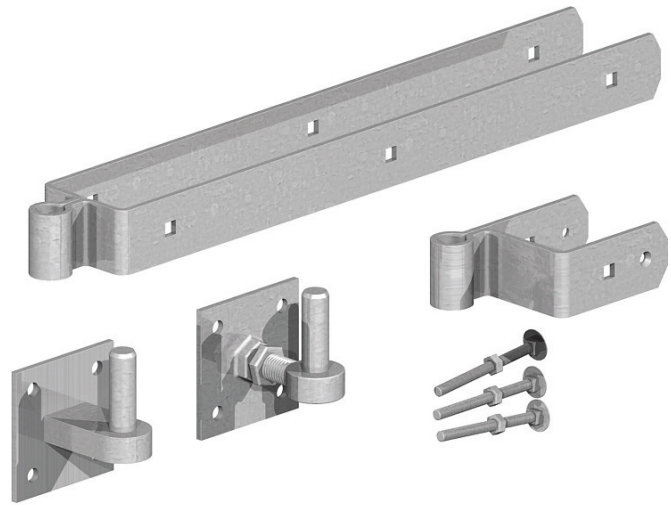

DESCRIPTION

This hinge set is designed to be mounted on a gate where there is a requirement for a 45-degree self-closing application i.e., on a pedestrian kissing gate. This type of hinge will only allow an opening aperture of 45 degrees and should be fitted between the posts (not on the front or back).

CONSTRUCTION

Constructed from mild steel.

GALVANISED: Coated in accordance with BS/EN ISO 1461:2009. The average coating thickness is 45 microns. If the product is fitted correctly and the surface finish is not damaged the service life of 15 years can be expected.

All items are coated in accordance with BS-13438.

FINISH

Galvanised

GATEMATE® Field Gate Self-Closing/Rising 45° Hinge Set

FINISH	SIZE INS (MM)	SUITABLE FOR	LOAD APPL.	MIN. ORDER QTY	OUTER CARTON QTY	PALLET QTY	CODE
Galvanised	18 (450)	3" gates	D	1	4	120	034 4511

Includes: 18" top band with 1" diameter eye, 5" bottom band with offset eye on corner, hook on 4" square plate, 3/4" diameter adjustable hook on 4" square plate and fixings. (Gate to be hung between posts).

FITTING INSTRUCTIONS ON PAGE 2

GATEMATE SELF CLOSING RISING HINGE SET 45°

HOW TO FIT THE SELF CLOSING/RISING HINGE SET 45°

The hinge sets require a minimum post size of 6" x 6" (150mm x 150mm) and are designed to mount a single gate. The gate must be hung on the inside face of the post.

STEP 01

Offer the top band (600mm) to the top rail of the gate. Ensure the neck of the band is snug to the hanging stile of the gate. Mark the fixing holes accordingly on both sides and remove the band. With a 12mm diameter drill bit drill the holes halfway through the top rail. Repeat from the other side. Push the bolts through and tighten up with nuts and washers provided. It is good practice to have all the bolt heads on the same side as the bolt heads of the gate cross bracing. This hinge set can be fitted to gates with either 3" or 4" slamming style when used in conjunction with a kissing gate application

STEP 02

Calculate the required finished height of the gate in the closed position allowing for ground clearance. Temporarily prop up the gate into the desired position and offer up the top hook-on-plate (non-adjustable type) into the eye of the band. Work out where the ideal place to fix this is, bearing in mind the bottom pin will be off set from this top plate due to the off eye on the bottom band. Pre-drill and fix with coach screws provided.

Now fit the offset-corner bottom band. Calculate the required position, which is generally in line with the bottom rail. Mark the holes, drill and pre drill appropriate holes, tightening fixings as necessary

STEP 03

With the gate still in the propped position now hang the gate on the top hook-on-plate to get the required mounting height for the bottom adjustable

hook-on-plate. It is an option to fit this upside down (pin facing down) to prevent unwanted removal of the gate. Disassemble the plate and offer the back plate up to the post marking the centre hole and four fixing holes. It is best practice to have the welded nut facing inwards to the post. Drill a 22mm diameter x 70mm deep hole in the post then enlarge the area around the mouth of the hole with a chisel to allow sufficient clearance for the welded nut, on the rear of the plate. Pre-drill the four fixing holes for the plate and attach with coach screws supplied.

Now hang the gate onto the top and bottom pins and adjust the bottom hook on plate as required.

Grease both pins on completion of fitting.

